

# APPAM FALL RESEARCH CONFERENCE

NOVEMBER 7 - 9, 2018

WASHINGTON MARRIOTT WARDMAN PARK - EXHIBIT HALL C - WASHINGTON, D.C.

**REVISION**  
Date: 5/29/2018  
By: DOMINIQUE SAUTIER, NERDC

BOOTH COUNT			
Inventory as of 06/22/2018			
Dimension	Size	Qty	SqFt
10'x10'	100	38	3,800
10'x23'-9"	237	1	237
Totals:		39	4,037

BLDG. LEGEND:

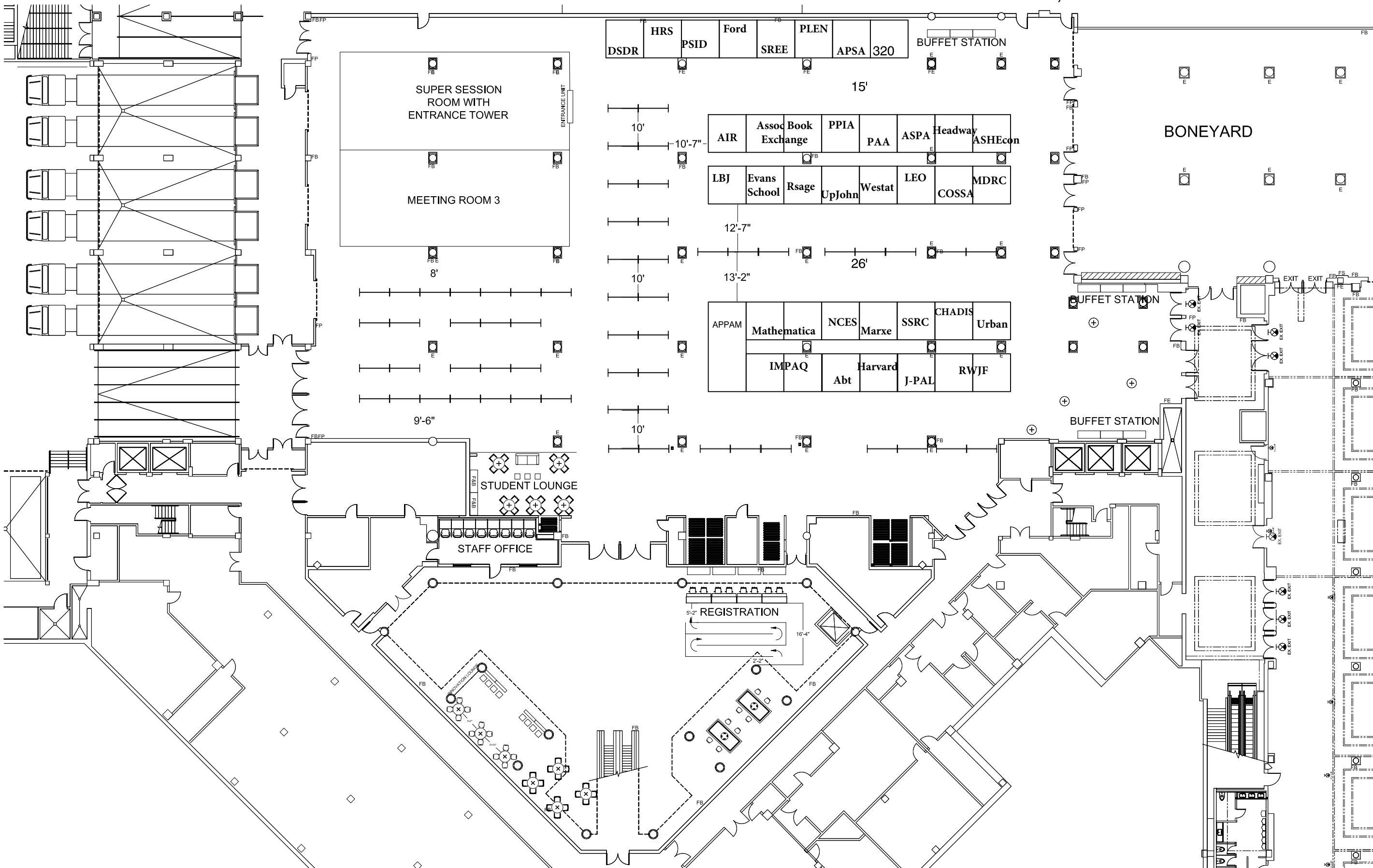

File Path: P:\Avon\BRANCH\NERDC\Floor Plans\Shows\1811\APPAM FALL RESEARCH - 463081\APPAM 1118 V2.dwg | Tab Name: OVERALL

**DRAWING INFO**  
Passport Line Item Number:  
**#4826596**  
Facility:  
WASHINGTON MARRIOTT  
WARDMAN PARK  
Hall / Level:  
EXHIBIT HALL C  
City & State:  
WASHINGTON, D.C.  
Scale: CUSTOM  
Job #: 463081  
AE: ELEANOR RAETHER  
Prod. AE: ELEANOR RAETHER  
Started: 6/22/2018  
Started By: DOMINIQUE SAUTIER, NERDC  
Prod. Branch: FREEMAN WASHINGTON

**FREEMAN**  
**Disclaimer** - Every effort has been made to ensure the accuracy of all information contained on this floor plan. However, no warranties, either expressed or implied, are made with respect to this floor plan. If the location of building columns, utilities or other architectural components of the facility is a consideration in the construction or usage of an exhibit, it is the sole responsibility of the exhibitor to physically inspect the facility to verify all dimension and locations.  
© Copyright 2007, Freeman Co. All rights reserved.  
**Confidential and Proprietary** - the information contained herein is the proprietary information of Freeman and by accessing the information, the recipient agrees to keep the information confidential and not disclose it to any third party without the prior consent of Freeman. Recipient also agrees to only use the information for its internal evaluation purposes and for no other purpose, without the prior consent of Freeman.